

**SECTIUNE 1 - 1**  
P2

TG 170 x 160 x 5 mm  
1 buc. / stalp  
- sc. 1/10 -

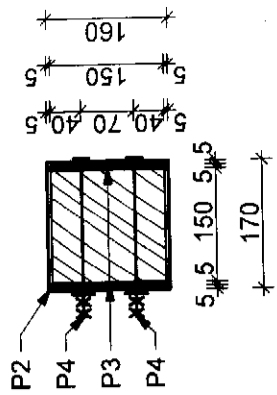

P3  
TG 150 x 150 x 5 mm  
2 buc. / stalp  
- sc. 1/10 -

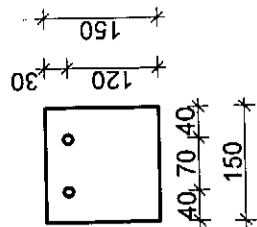

Stalp lemn  
15 x 15 cm

P2 - 1 buc. / stalp  
TG 170 x 160 x 5 mm

P4 - 2 buc. / stalp  
M10 + s + 2p...L total = 200 mm

P3 - 2 buc. / stalp  
TG 150 x 150 x 5 mm

C.T.N.

6 bucati de plasa sudata PC52  
Ø6/100 x Ø6/100 mm

50 x 50 cm

legate cu sarma neagra

P1 - 2 buc. / stalp  
2Ø12 PC52  
L = 155 cm

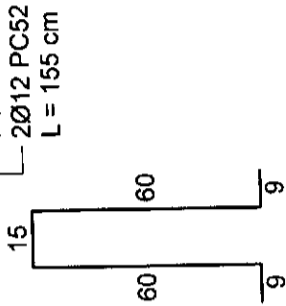

P1  
2Ø12 PC52...L = 155 cm  
sudate de placuta P2, pe latura de 170 mm,  
la 20 mm interax fata de margini

**Nota**

1. Praznurile P1 si placutele P3 se vor suda de placa P2 pe tot perimetrul de contact, prin cordoane de sudura cu grosimea de 3,5 mm.
2. Ansamblul de elemente metalice pentru prinderea stalpilor se va monta in fundatii inainte de turnarea betonului, asigurandu-se ancorarea de plasele sudate.

**Materiale**

Beton armat in fundatii: C16/20 - XC2; A/C=0,60; 260 kg CEM II A-S 32,5N/mc;

clasa S3; agregate 0.....31 mm ;

Armare: plase sudate PC52 Ø6/100 x Ø6/100 mm, PC 52 ;

Acoperire cu beton: 5 cm ;

Laminare OL 37.2n.

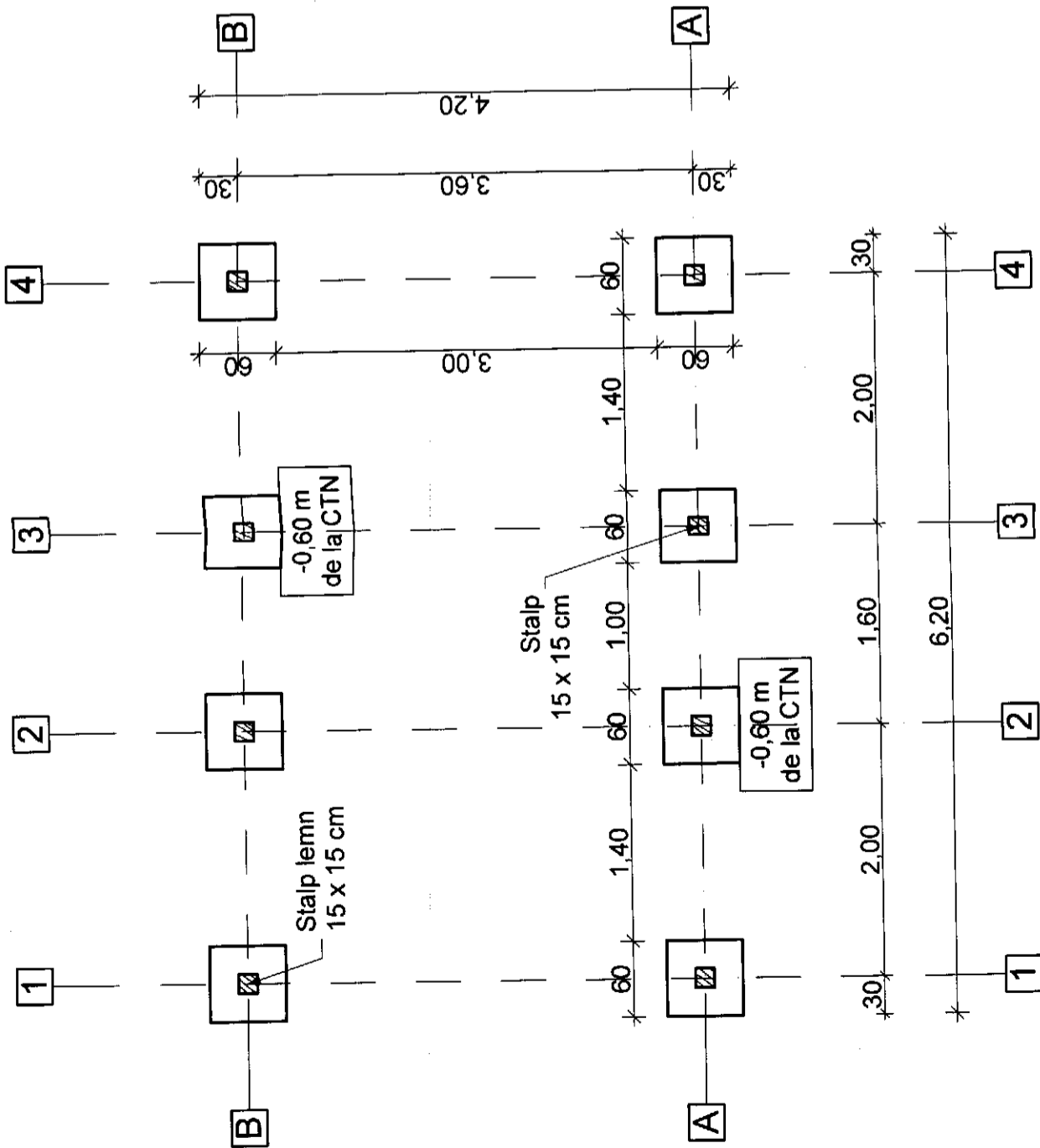
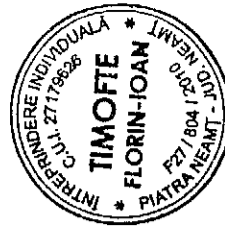

| NUME        | SEMNATURA           | CERINTA          | REFERAT / EXPERTIZA NR. / DATA  |
|-------------|---------------------|------------------|---|
| LABORATOR   | NUME                | SEMNATURA        | Beneficiar:<br><b>COMUNA BICAZU ARDELEAN</b>  |
| SEF PROIECT | ing. Timofte Florin | Scara:<br>1/50   | Proiect:<br>CONSTRUIRE POPAS TURISTIC IN SATUL TELEAC,<br>COMUNA BICAZU ARDELEAN, JUDETUL NEAMT |
| PROIECTAT   | ing. Timofte Florin | 1/20             | Faza:<br>P.Th.  |
| DESENAT     | ing. Timofte Florin | Data:<br>09.2017 | Denumire plansa:<br><b>PLAN SI DETALII FUNDATII</b>   |
|             |                     |                  | Planşa<br>RI  |